

BRONZE 400 WOG Y-STRAINER

Features:

- 400 WOG
- 250 PSI Steam
- Solder Ends
- Solder Ends Comply With ANSI/ASME B16.18
- Cast Bronze Body
- 20 Mesh Stainless Steel Screen
- Blow-off Plug Included
- Test Pressure:
 Shell (Hydro) - 600 PSI



Cv & Weight (lbs.)

Size	Cv	Wt (Lbs)
1/2	9.2	0.73
3/4	17.5	1.28
1	28	1.89
1-1/4	45	2.89
1-1/2	62	4.32
2	96	6.83

Figure Number Matrix

F N W 510 SIZE	
SIZE CODES	
1/2 = D	1-1/4 = H
3/4 = F	1-1/2 = J
1 = G	2 = K
REPLACEMENT SCREENS	
1/2 = FNW510SD	
3/4 = FNW510SF	
1 = FNW510SG	
1-1/4 = FNW510SH	
1-1/2 = FNW510SJ	
2 = FNW510SK	

BRONZE 400 WOG Y-STRAINER

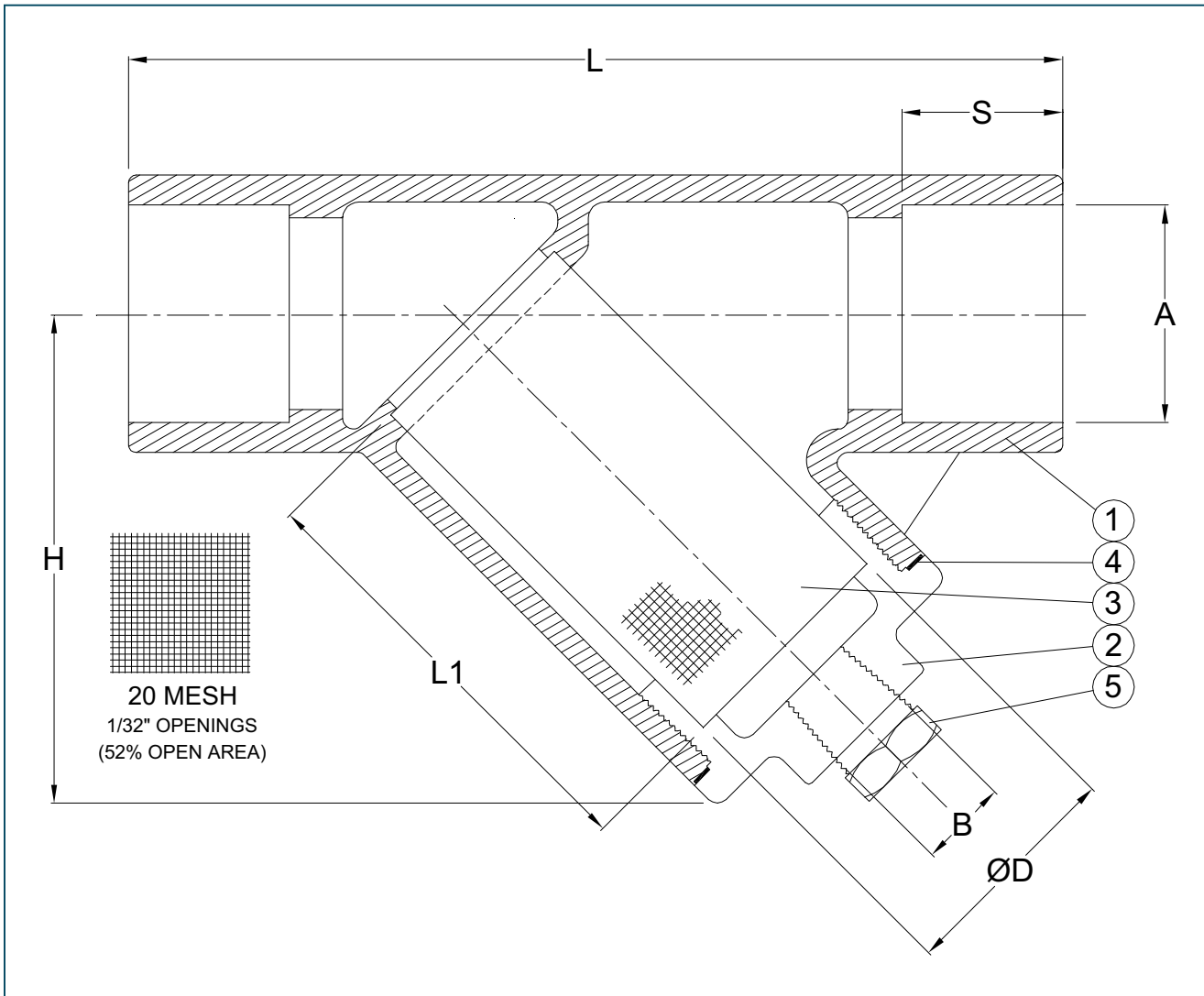

Dimensions (Inches)

SIZE	L	H	B (npt)	L1	ØD	A		S
						Min	Max	
1/2	2.94	1.56	1/4	1.14	0.62	0.6275	0.6310	0.50
3/4	3.63	1.89	1/4	1.49	0.88	0.8775	0.8810	0.75
1	4.48	2.61	3/8	2.08	1.12	1.1280	1.1315	0.91
1-1/4	5.13	3.25	3/8	2.63	1.38	1.3780	1.3815	0.97
1-1/2	5.81	3.59	1/2	2.95	1.69	1.6285	1.6325	1.09
2	7.32	4.45	1/2	4.01	2.16	2.1285	2.1325	1.34

Standard Materials

Ref. No.	Description	Material	Qty
1	Body	Bronze ASTM B584-C84400	1
2	Cover	Bronze ASTM B584-C84400	1
3	Screen	Stainless Steel ASTM A167-304	1
4	Gasket	Non-Asbestos	1
5	Plug	Brass 36000	1

DOC: FNW510BYS08 Ver. 3/09

© 2009 - FNW. All rights reserved.
The FNW logo is a registered trademark of Ferguson Enterprises, Inc.

The contents of this publication are presented for information purposes only, and while effort has been made to ensure their accuracy, they are not to be construed as warranties or guarantees, expressed or implied, regarding the products or services described herein or their use or applicability. All sales are governed by our terms and conditions, which are available on request. We reserve the right to modify or improve the designs or specifications of our products at any time without notice. Always verify that you have the most recent product specifications or other documentation prior to the installation of these products.